



90 SERIES

THICK TURRET

T-90

A/B Station

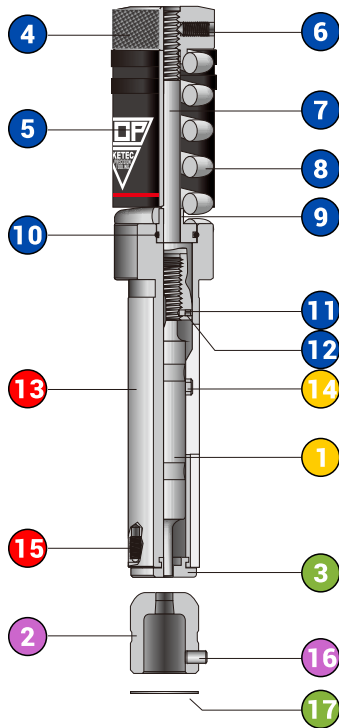

DESCRIPTION

- 1 Punch
- 2 Die
- 3 Stripper
- 4 Punch Head
- 5 Canister
- 6 Socket Head Cap Screw
- 7 Driver
- 8 Spring
- 9 Spring Retainer
- 10 O Ring
- 11 Steel Ball
- 12 Retaining Ring
- 13 Guide
- 14 Dowel Pin
- 15 Ball Plunger
- 16 Dowel Pin
- 17 Die Shim

= Punch Assembly
 = Punch Head Assembly
 = Punch
 = Die
 = Guide

A Station: ØD ~12.7mm (~½") B Station: ØD ~31.7mm (~1-¼")

PRODUCT OVERVIEW

Ketec's T90 series is one of Ketec's best-selling product lines, prized for its ease of use, reliability, and popularity. Our T90 series can be equipped with ABS (standard) and other industry common features. All categories are available in stations A, B, C, D and E, offering other mainstream tooling manufacturers.

- Tool-free punch length adjustment is achieved by rotating the punch body clockwise or counterclockwise and locked in place by retaining ring and index pin.
- Max grind life for A & B station is 6.3mm.
- Using HRC 63 High-Speed Steel for exceptional durability in high-stress environments.
- Guides treated with Nitriding process to enhance compressive, wear, and corrosion resistance.
- TiCN coating available upon request for additional protection.
- Interchangeable with other mainstream tooling manufacturers.

T90 Series Parts Availability Chart

Parts	Punch Assembly	Punch Head Assembly	Punch	Die	Open Guide	Stripper Plate
T90	●	●	●	●	●	●
T90 ABS	●	●	●	●	●	●

Standard Shapes Round

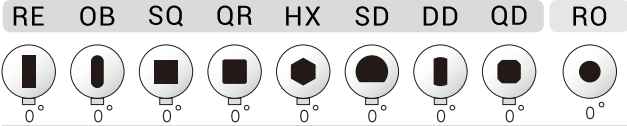

DESCRIPTION

- | | |
|---------------------|--------------------|
| 1 Punch | 13 Adjusting Shaft |
| 2 Die | 14 Lock Washer |
| 3 Stripper | 15 ABS Screw |
| 4 Punch Head | 16 Spring Support |
| 5 Retainer Ring | 17 Punch Holder |
| 6 Adjustment Button | 18 Punch Screw |
| 7 Canister | 19 Guide |
| 8 Disc Spring | 20 Clip Screw |
| 9 Punch Head Scew | 21 Stripper Clip |
| 10 Guide Lock Screw | 22 Dowel Pin |
| 11 Key Screw | 23 Ejector |
| 12 Driver | 24 Die Shim |

 + + + 3 = Punch Assembly

 Guide Assembly

 Punch

 Guide

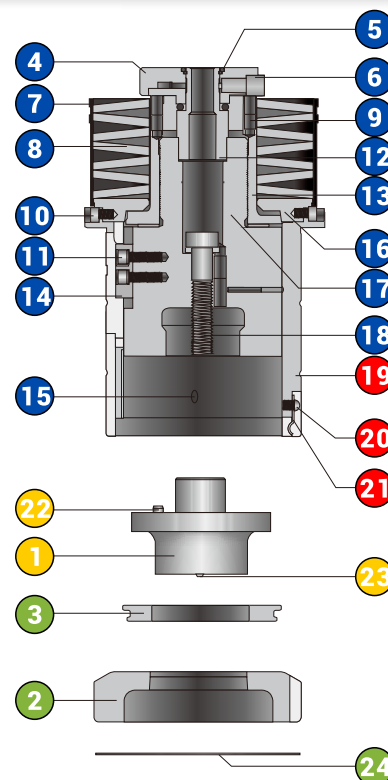

C Station: ØD ~50.80mm (~2")

D Station: ØD ~88.90mm (~3-1/2")

E Station: ØD ~114.30mm (~4-1/2")

PRODUCT OVERVIEW

Ketec's T90 series is one of Ketec's best-selling product lines, prized for its ease of use, reliability, and popularity. Our T90 series can be equipped with ABS (standard) and other industry common features. All categories are available in stations A, B, C, D and E, offering other mainstream tooling manufacturers.

T90 Series Parts Availability Chart

Series	Parts	Punch Assembly	Punch Head Assembly	Punch	Die	Guide	Guide Assembly	Stripper Plate
T90		●	●	●	●	●	●	●
T90 ABS		●	●	●	●	●	●	●

Standard Shapes

Round

	RE	OB	SQ	QR	HX	SD	DD	QD	RO
C									
D									
E									

- Tool-free punch length adjustment is achieved by pressing the quick adjust button and rotating the punch head clockwise or counterclockwise.
- Max grind life for C, D, E station is about 8mm.
- Using HRC 63 High-Speed Steel for exceptional durability in high-stress environments.
- TiCN coating available upon request for additional protection.
- Rooftop shear available upon request.
- Guide comes in 3 standard pin angles of 0°, 90°, 225°.
- Interchangeable with other mainstream tooling manufacturers.



Contact



North America

+1 (339) 233-4347(Charlie Qi)

China

+86 20 37965500(Christy Wen)
+86 188-1981-5253(Simon Tam)



North America

Charlie.q@ketectooling.com

China

International@ketectool.com
Simon.t@ketectooling.com



WhatsApp

+1 518-837-1464(North America)
+86 188-1981-5253(International)



Fax

020-3769 5393



North America

14276 Doolittle Dr, San Leandro, CA, 94577, USA

China

No.7,Lifeng Road, Mingzhu Industrial Park, Conghua, Guangzhou, China

Follow Us

